

Asset Management Plans 2024

Assets

24 October 2023



Purpose

To provide an overview of:

- Asset Management Plan (AMP) development and process with SMP, Delivery Plan and Budget
- Current Intervention Levels
- Community Expectations
- Intent to consult on expectations

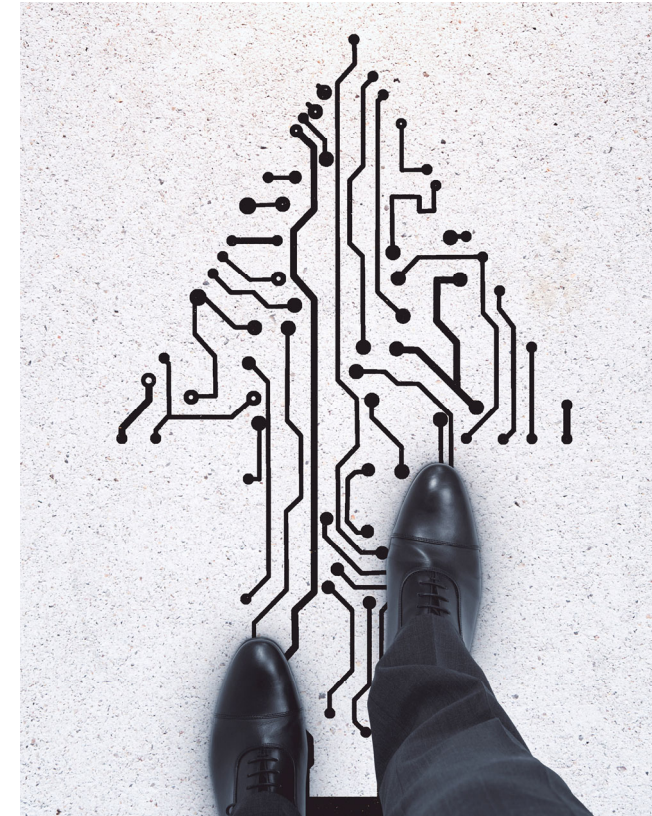

Approach

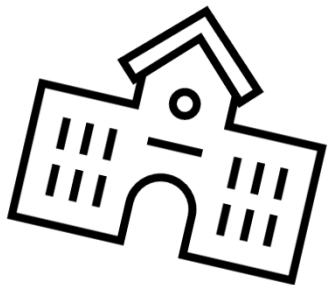
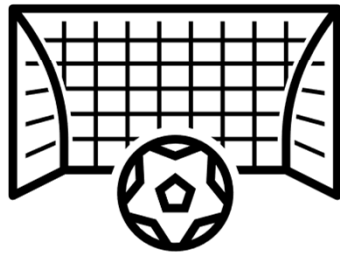
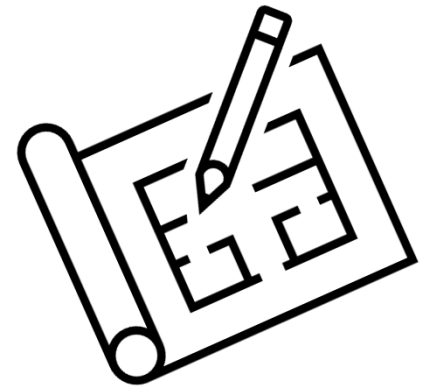

- Joint approach including Buildings, Transport, Open Space & Stormwater assets
- Focusing on built, significant, financial assets
- Different to other recent consultations – SMP, ITP

Around the Room

- 1) Are you comfortable with seeking community expectations to asset intervention levels and performance?

2023/24 →

COUNCIL
ENGAGEMENT

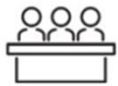

PRE-AMP COMMUNITY
ENGAGEMENT



INFORM
STRATEGIC PLANS



BUILD AMPS



AMP COMMUNITY
CONSULTATION



AMP
ENDORSEMENT



- 2) To help us shape the questions, what do you need to hear from the community to make informed decisions regarding Councils future asset investment?

Tonight's Session

- Refresher on AMPs and service levels
- Informing asset investment
- Asset management challenges
- The case for pre-AMP consultation
- Planned approach & feedback



What Are AMPs?

- Planning documents forecasting the performance and funding requirements of an asset network over time (10yrs)
- Combines asset condition, attribute data & financial information
- Developed at a minimum of every 4 years – November 2024
- Service levels – how vs. how often we intervene

What Do AMPs Do?

- Identify future asset works - CWP
- Inform the LTFP & strategic plans
- Inform decision makers of future consequences
- One-stop-shop for the community to understand their assets

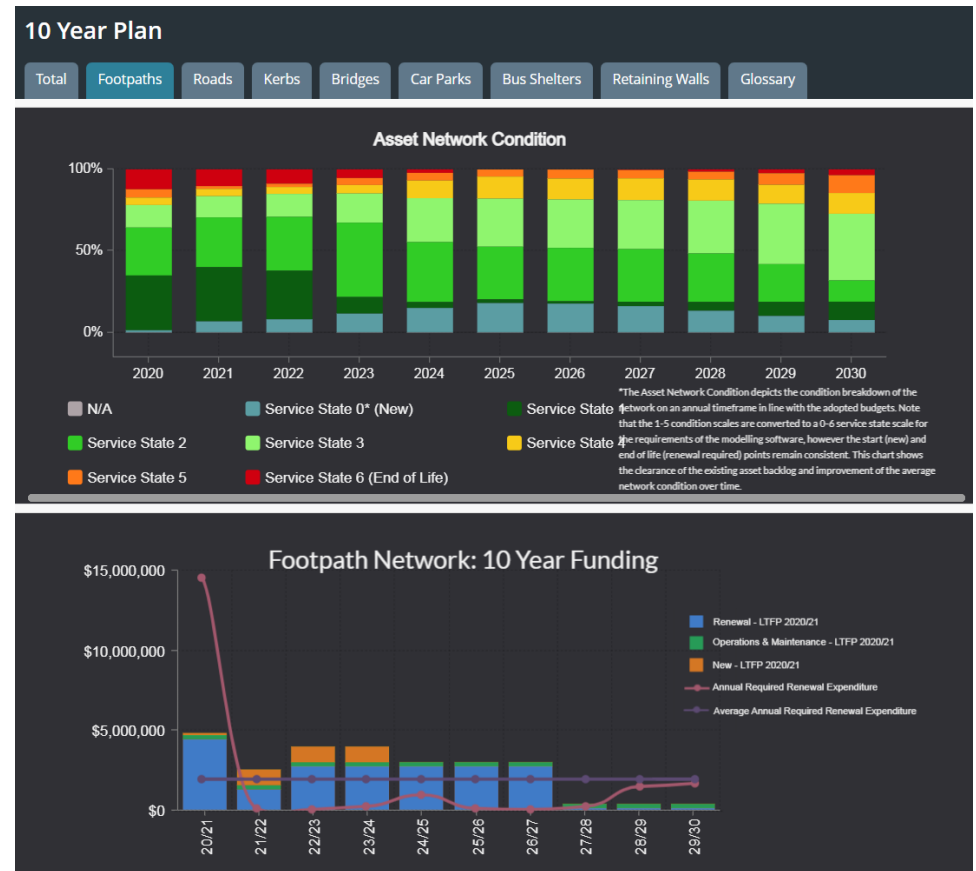

Asset Management Activities

- Operational
- Maintenance
- Capital renewal
- Capital upgrade/new

Each asset class has unique challenges



Current Intervention Levels - Transport

- Historical focus on 'backlog'
- Capital – when we replace or upgrade assets
- Maintenance – how assets are managed to reach the point of replacement



Current Intervention Levels - Transport

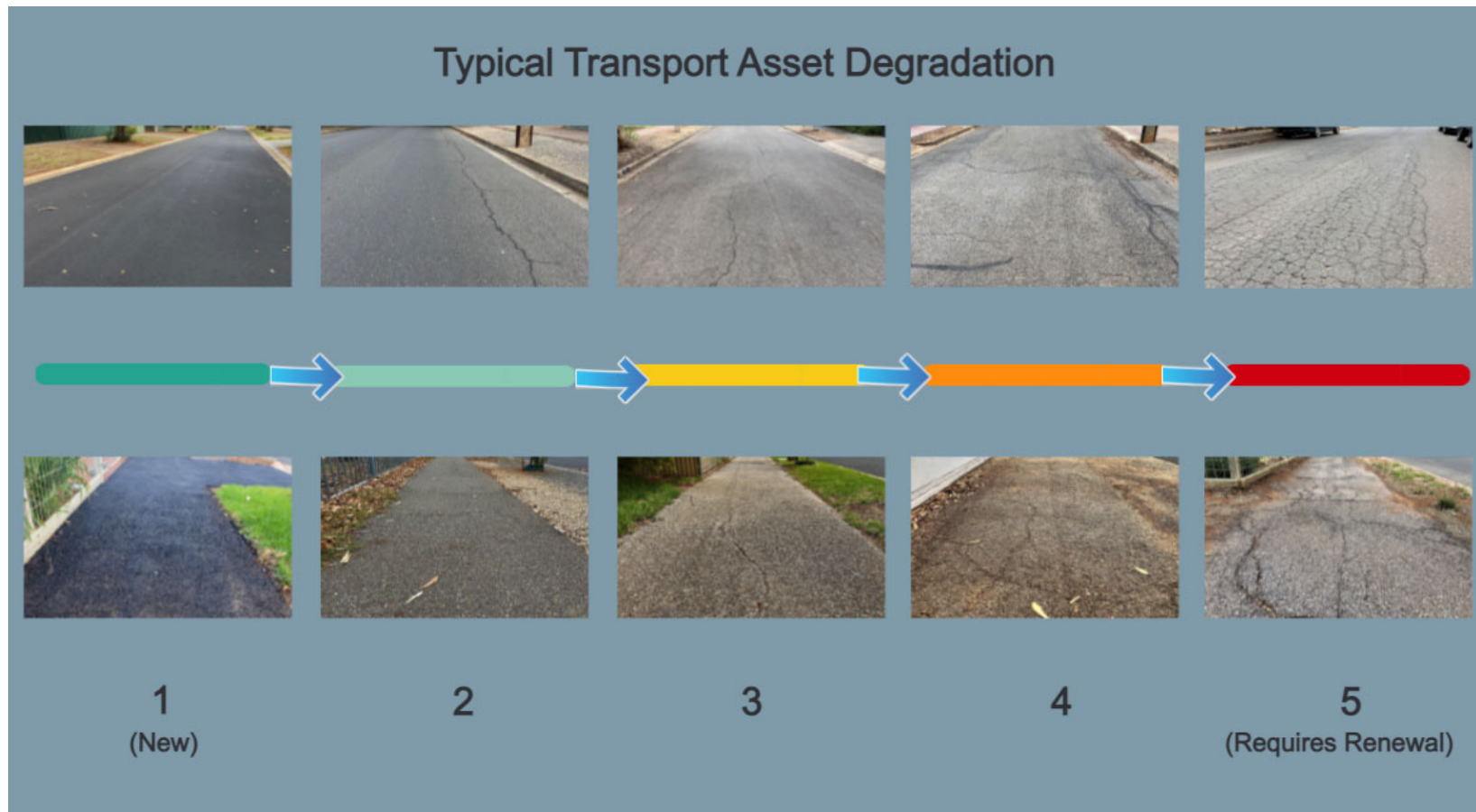

Asset Category - Buildings

- **Building assets are complex**
 - Diverse buildings portfolio
 - Varying components
 - Multiple contractors
- Lack of information to inform previous AMPs
- BAMP Improvement Plan



Asset Classification - Buildings

BUILDING CLASSIFICATIONS - Component Groups

- Super Structure
- Roofing
- Services
- Fitout
- Buildings

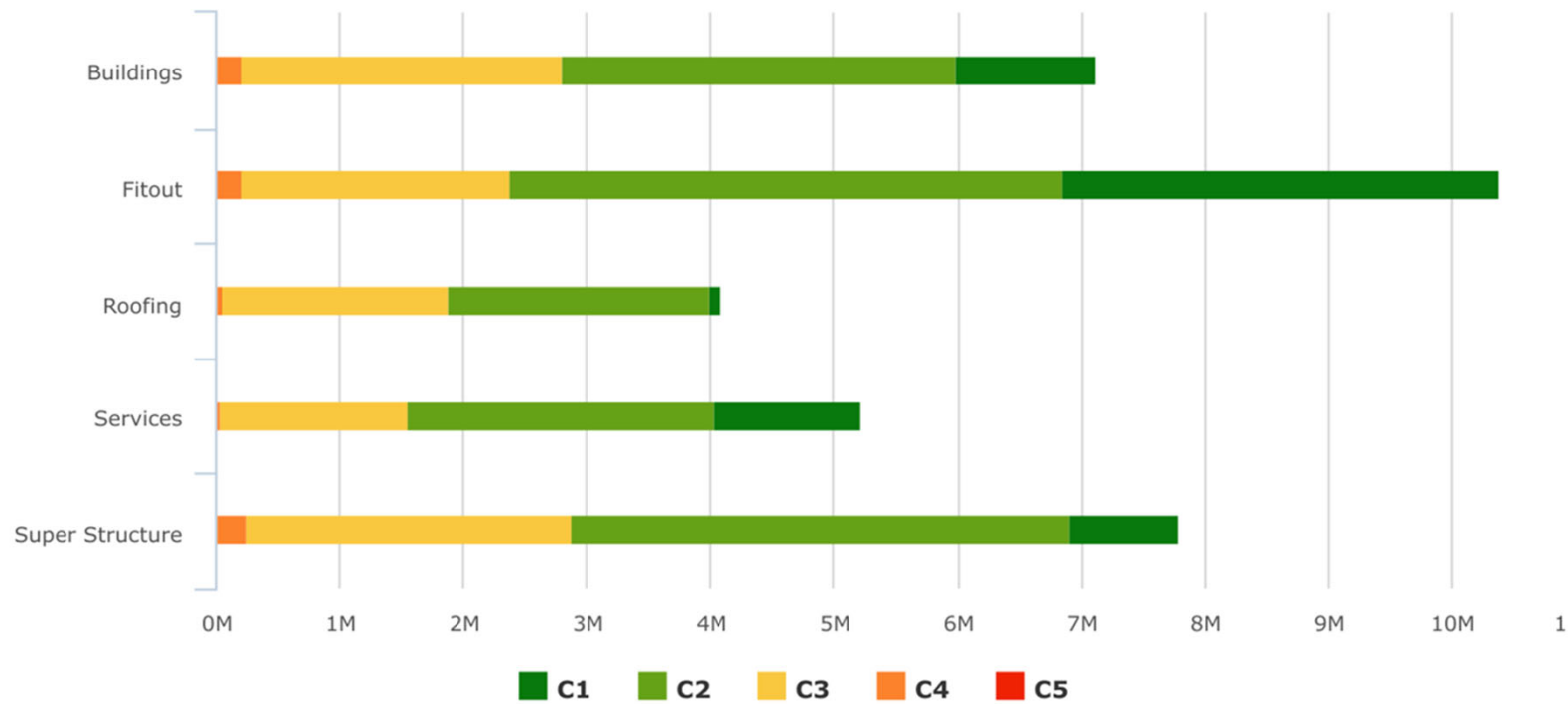

Asset Classification - Buildings

BUILDING CLASSIFICATIONS - Building Condition Audit Data



1
(New)

2

3

4

5
(Requires Renewal)

Intervention Levels - Buildings

HOLISTIC APPROACH -

Service Levels and Asset Management

- Building Asset Classification
- Community Feedback
- Live Condition Audit

INFORMED FORWARD PLANNING

- Maintenance, Renewal, Upgrade, Disposal
- DDA Compliance Assessment and Upgrades underway
- Sustainability and Environmental Initiatives
- Coordination with other asset groups

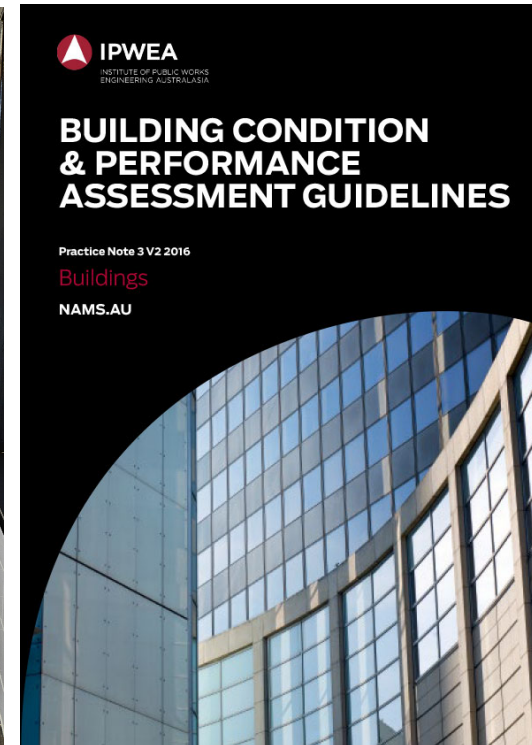

Community Expectations - Open Space

- There is diversity!
- **65 asset types** - from Oval Lighting to Bins
- **Playgrounds:**
 - Community expects an **upgrade** (not 'like for like')
 - DDA pathways
 - Artificial shade
 - Additional seating



Community Expectations – Open Space

Open Spaces are changing:

- Bespoke equipment
- Nature play
- Multi-need/multi-age
- Placemaking



Welcoming, inspiring, engaging

Current Intervention Levels – OS

Typical Open Space Asset Degradation

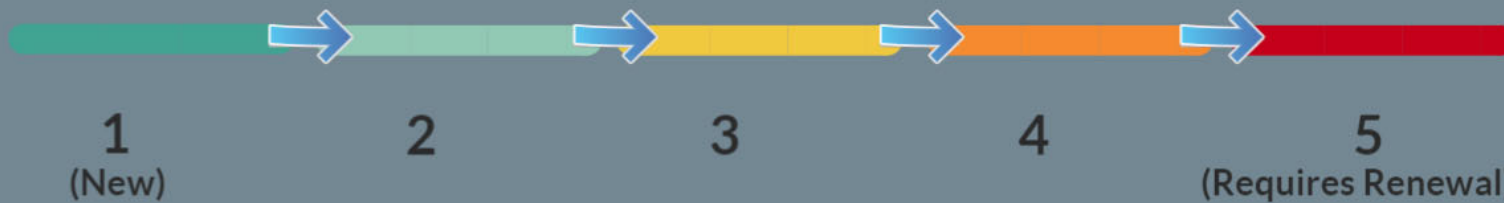

Why Consult?

- Increasing pressure on budgets – markets/community expectations
- Increasing impacts from external factors – storms/climate
- Gives the community an opportunity to provide feedback

Informs future decision making (Budget, SMP, Delivery Plan)

Strategic Framework

- AMPs + Informs Annual Budget, SMP, Delivery Plan



Engagement Process

2019/20 →

COUNCIL
ENGAGEMENT

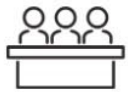

BUILD AMPS



AMP COMMUNITY
CONSULTATION



AMP
ENDORSEMENT



+ 2021 Internal Audit

2023/24 →

COUNCIL
ENGAGEMENT

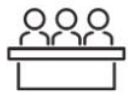

PRE-AMP COMMUNITY
ENGAGEMENT



INFORM
STRATEGIC PLANS



BUILD AMPS



AMP COMMUNITY
CONSULTATION



AMP
ENDORSEMENT



'Pre-AMP' Consultation

- Seeking feedback on intent to consult to inform Budget, SMP, Delivery Plan, AMP and LTFP rather than detail of the engagement
- Questions will be strategically developed, focusing on themes of:
 - Importance
 - Condition
 - Priority of investment

Around the Room

- 1) Are you comfortable with seeking community expectations to asset intervention levels and performance?

2023/24 →

COUNCIL
ENGAGEMENT

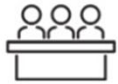

PRE-AMP COMMUNITY
ENGAGEMENT



INFORM
STRATEGIC PLANS



BUILD AMPS



AMP COMMUNITY
CONSULTATION



AMP
ENDORSEMENT



- 2) To help us shape the questions, what do you need to hear from the community to make informed decisions regarding Councils future asset investment?

Next Steps

Endorsements of draft AMP consultation & draft AMP

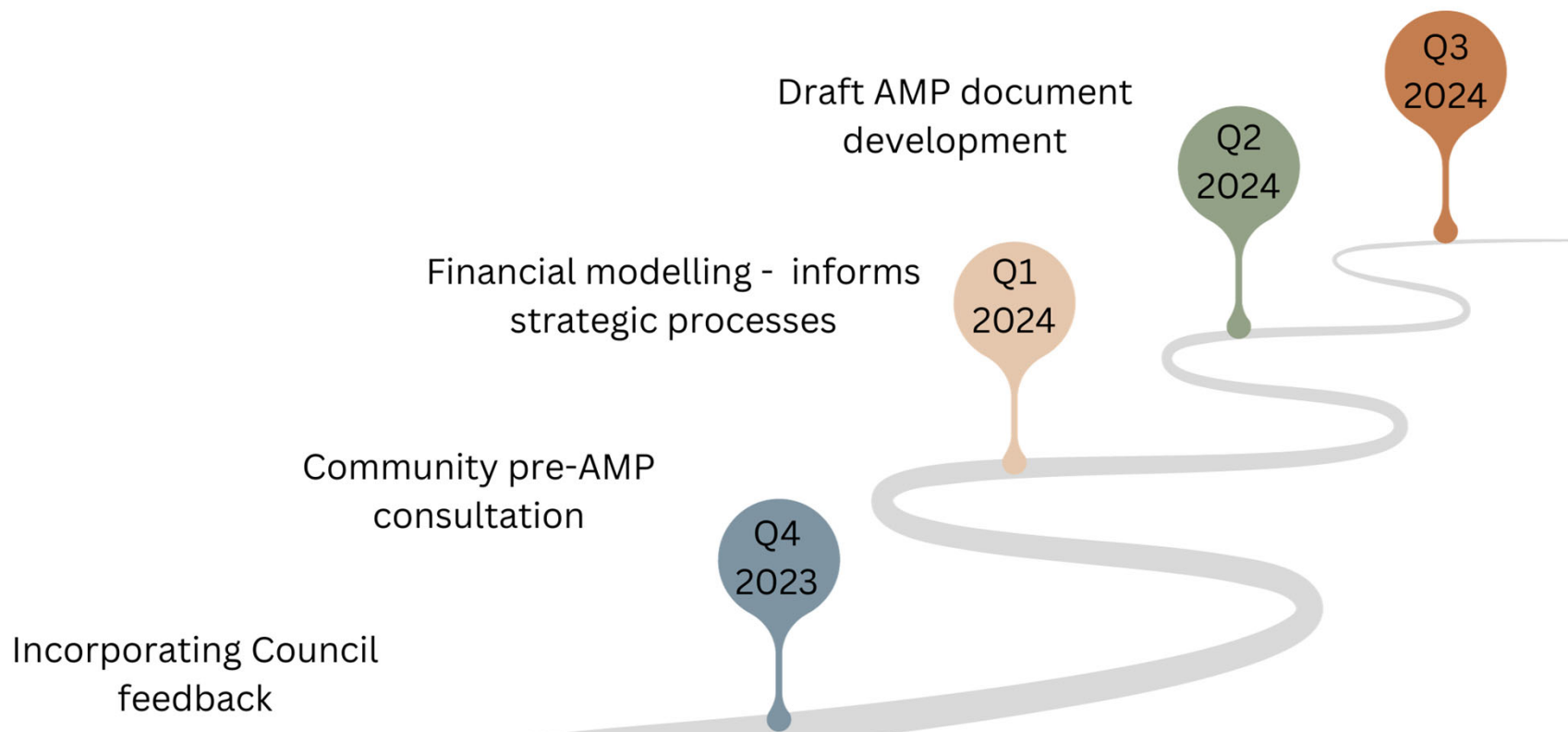



Examples...

Rankings (priority and emoji)

The **'Transport'** asset category includes a number of asset types as detailed below. How would you prioritise the importance of **maintaining** these existing assets? (Order from first priority to last priority)

Overall, when large rainfall events occur, properties and people are protected from flooding.



Strongly disagree



Disagree



Neutral



Agree



Strongly agree

Selections (checkbox)

If you could add more of a certain **Open Space Asset** into the City of Mitcham, what would it be? (select top 3)

Likerts (rating scale)

Within the City of Mitcham, do you find the **footpaths** to be:

	Strongly agree	Agree	Neutral	Disagree	Somewhat disagree
Well maintained	<input type="radio"/>	<input type="radio"/>	<input type="radio"/>	<input type="radio"/>	<input type="radio"/>
Upgraded and replaced as needed	<input type="radio"/>	<input type="radio"/>	<input type="radio"/>	<input type="radio"/>	<input type="radio"/>
Meeting your needs	<input type="radio"/>	<input type="radio"/>	<input type="radio"/>	<input type="radio"/>	<input type="radio"/>
Safe	<input type="radio"/>	<input type="radio"/>	<input type="radio"/>	<input type="radio"/>	<input type="radio"/>

Comments

Please help us understand your response by providing a short comment:

Please add your comment here...